

NOTES:

1. MATERIALS: FIBERGLASS EPOXIED MEDIA, ANODIZED ALUMINUM, STAINLESS STEEL CORE TUBE; SEE BOM ON PAGE 2
2. MAX OPERATING TEMPERATURE: 350 °F
3. FLOW DIRECTION: IN-TO-OUT
4. MOUNTING: VERTICAL
5. MEDIA GRADES 03 & 08: PARTICULATE EFFICIENCY >99.999% from 0.3 - 1.0 µm
6. LASER ETCH PLUG WITH PART #, JOB#, AND NORMAN FILTER COMPANY'S NAME, WEB ADDRESS, AND PHONE#
7. CLEAN PER APPROVED ROUTING INSRUCTIONS
8. SPOT WELD PER APPROVED ROUTING INSTRUCTIONS
9. ROLL COALESCING MEDIA TIGHTLY AROUND CORE TUBE MAKING SURE TO KEEP MEDIA CENTERED, SLIDE S.S. OUTER WRAP OVER COALESCING MEDIA
10. EPOXY:
 - A. AFFIX THE PLUG AND END FITTING ONTO THE CORE TUBE ASSEMBLY USING A PREDETERMINED AMOUNT OF EPOXY
 - B. EPOXY PLUG AND END FITTING TO THE OPPOSITE ENDS OF WRAPPED MEDIA SUBASSEMBLY
 - C. EPOXY SPRING TO PLUG (IF APPLICABLE)
11. PLACE ENTIRE ASSEMBLY IN DRYER, CURE EPOXY PER APPROVED ROUTING INSTRUCTIONS

REVISIONS			
DRAWING REV.	DESCRIPTION	DATE	APPROVED
-	PER ECO 1203: INITIAL RELEASE	3/10/17	JB
A	PER ECO 1615: UPDATE BOM WITH OUTER WRAP AND COALESCING MEDIA	2/27/18	KH

FLOW PROPERTIES

'XXX' CODE	FLOW RATE SCFM @ 10 PSID
	3000 psig
535	300
536	600
586	1200
587	2500
588	4000
549	10000
U-115	225

COALESCING MEDIA PROPERTIES

'CM' MEDIA GRADE 'YY' CODE	AIR EFFICIENCY	PRESSURE DROP	WATER REPELLENCY	OIL REPELLENCY	OIL CARRY-OVER	BASIS WEIGHT	CALIPER	APPLICATION
	%	mmH2O	mmH2O	3M TEST KIT	mg/m ³	g/m ²	µm	
03	99.997	41	900	oleophobic (9)	<0.005	78	450	High efficiency particulate & oil removal from compressed air
08	95.0	14	900	oleophobic (10)	<0.01	76	510	
09	80.0	8.2	600	oleophilic	<0.01	84	550	
13A	70.0	6.0	600	oleophobic (9)	<0.20	84	600	Vacuum pump & air-oil separation compressor
13W	75.0	5.6	600	oleophobic (12)	<0.15	86	700	
15	50.0	3.8	550	oleophobic (9)	<0.20	78	550	
30	15.0	1.1	250	oleophobic (11)	<0.4	65	500	Low efficiency pre-filtration & air-oil separation for compressors

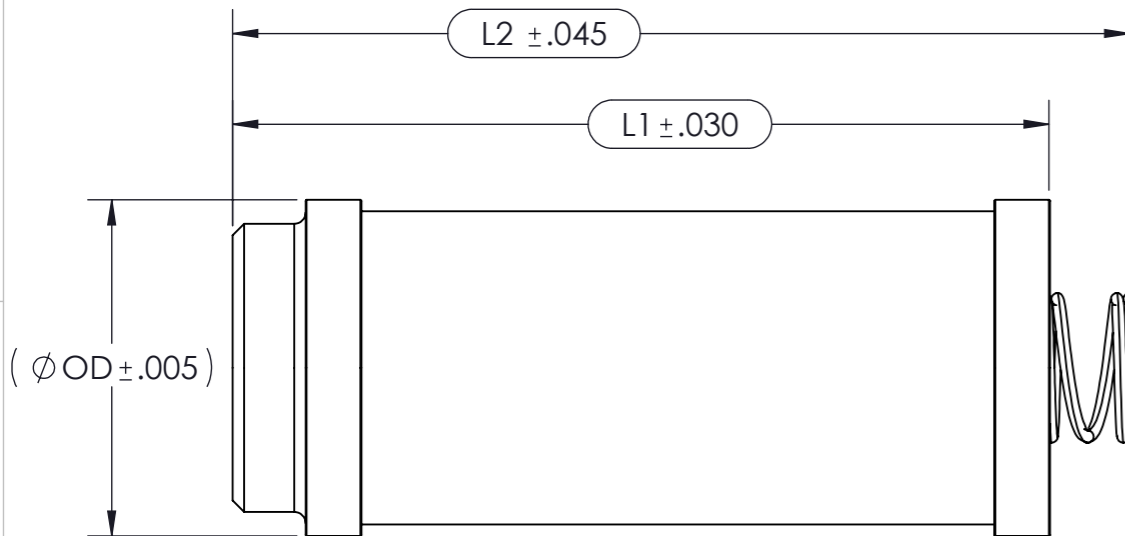

UNLESS OTHERWISE SPECIFIED DIMENSIONS ARE IN INCHES

TOLERANCES ON:
 2 PLACE DECIMAL: .XX +/-0.01
 3 PLACE DECIMAL: .XXX +/-0.005
 ANGULAR: +/- 0.5°

PART TO BE FREE OF BURRS
 REMOVE SHARP EDGES (FILLET 0.005" - 0.020") DO NOT INSPECT
 SURFACE FINISH 125 Ra UNLESS NOTED OTHERWISE DO NOT INSPECT
 IF PART REVISION IS NOT SPECIFIED, PART REV. MATCHES DRAWING REV.

TITLE: 4500 SERIES COALESCING MEDIA ELEMENTS		PART REV: -
PART NUMBER: XXXC-YYB		PART REV: -
DWG NO. XXXC-YYB	CAGE CODE 59165	SIZE A3

DO NOT SCALE DRAWING

SCALE:1:2

SHEET 1 OF 2

O-RING OPTION TABLE

'B' CODE	O-RING MATERIAL
M	TEFLON™
M1	TEFLON PER AMS 3678C-1-B
E	ETHYLENE PROPYLENE
E1	V1238-95
S	SILICONE
L	BUNA-N
K	90 DUROMETER NITRILE
HNBR	HNBR
H	4079 KALREZ™
N	VITON
MN	TEFLON COATED VITON

™ REGISTERED TRADEMARK OF DUPONT

REVISIONS			
DRAWING REV.	DESCRIPTION	DATE	APPROVED
-	ECO: 1203	3/10/17	JB

DIMENSIONAL TABLE

'XXX' CODE	L1	L2	Ø OD
535	4.250	4.665	1.750
536	6.112	6.527	1.750
586	6.770	7.185	2.000
587	6.740	7.155	2.300
588	9.300	9.715	2.300
549	12.710	13.125	3.100
U-115	3.180	3.595	1.625

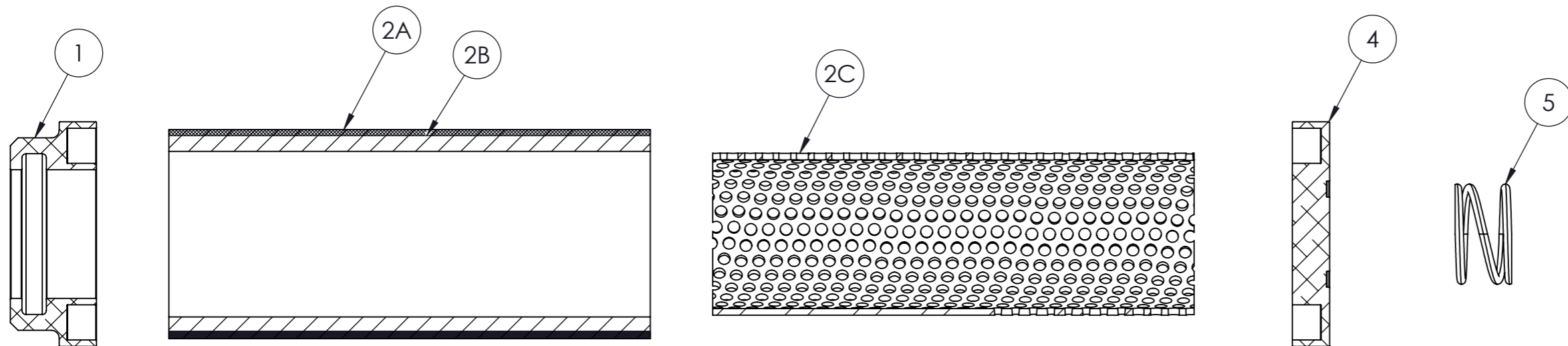
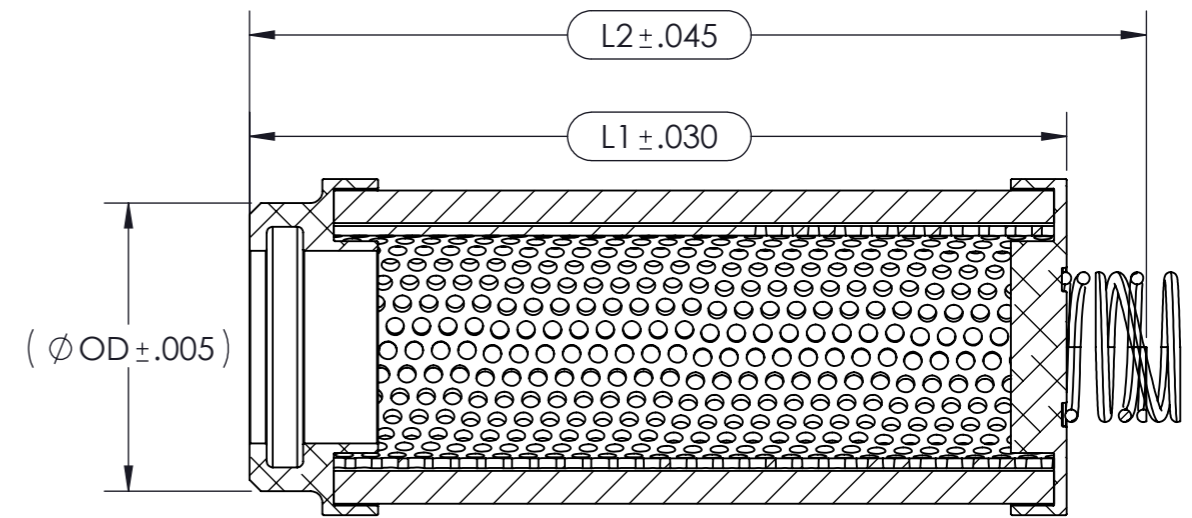

ITEM	PART NUMBER	DESCRIPTION	QTY	MATERIAL
1	EF-XXXC-ZYY	END FITTING	1	ALUMINUM
2	EMSA-XXXC-CMY	MESH PACK SUBASSEMBLY	1	MULTIPLE
2A	OW-XXXC	EMO2 WIRE MESH OUTER WRAP	1	316 S.S.
2B	CMYY	COALESCING FILTRATION MEDIA	AS REQ	COALESCING MEDIA
2C	ECT-XXXC	CORE TUBE SUPPORT	1	316 S.S.
3	EPL-XXXC-ZYY	END PLUG	1	ALUMINUM
4	Q-63	SPRING	1	316 S.S.

UNLESS OTHERWISE SPECIFIED
DIMENSIONS ARE IN INCHES

TOLERANCES ON:
2 PLACE DECIMAL: .XX +/-0.01
3 PLACE DECIMAL: .XXX +/-0.005
ANGULAR: +/- 0.5°

PART TO BE FREE OF BURRS
REMOVE SHARP EDGES (FILLET 0.005" - 0.020") DO NOT INSPECT
SURFACE FINISH 125 Ra UNLESS NOTED OTHERWISE DO NOT INSPECT
IF PART REVISION IS NOT SPECIFIED, PART REV. MATCHES DRAWING REV.

NORMAN FILTERS 3/10/17
NORMAN FILTER COMPANY
 9850 SOUTH INDUSTRIAL DRIVE - BRIDGEVIEW, IL 60455
 PHONE (708)430-4000 - FAX (708)430-5961

TITLE: 4500 SERIES COALESCING MEDIA ELEMENTS

PART NUMBER: XXXC-YYB PART REV: -

DWG NO. XXXC-YYB CAGE CODE 59165 SIZE A3

SCALE: 1:2 SHEET 2 OF 2

DO NOT SCALE DRAWING